

# National Amyloidosis Centre

*Directions and map of surrounding area*



***Directions (see following map):***

Enter the hospital via the Medical School entrance on Rowland Hill Street.  
Walk straight ahead through the double doors located to the left of the stairs  
(signposted above the doors).  
Continue down the corridor through two further sets of double doors.  
Turn right just before the end of the corridor and take the lift to the **Lower 3<sup>rd</sup> Floor**.  
Turn left out of the lift and press the call button to gain entry to the Centre.

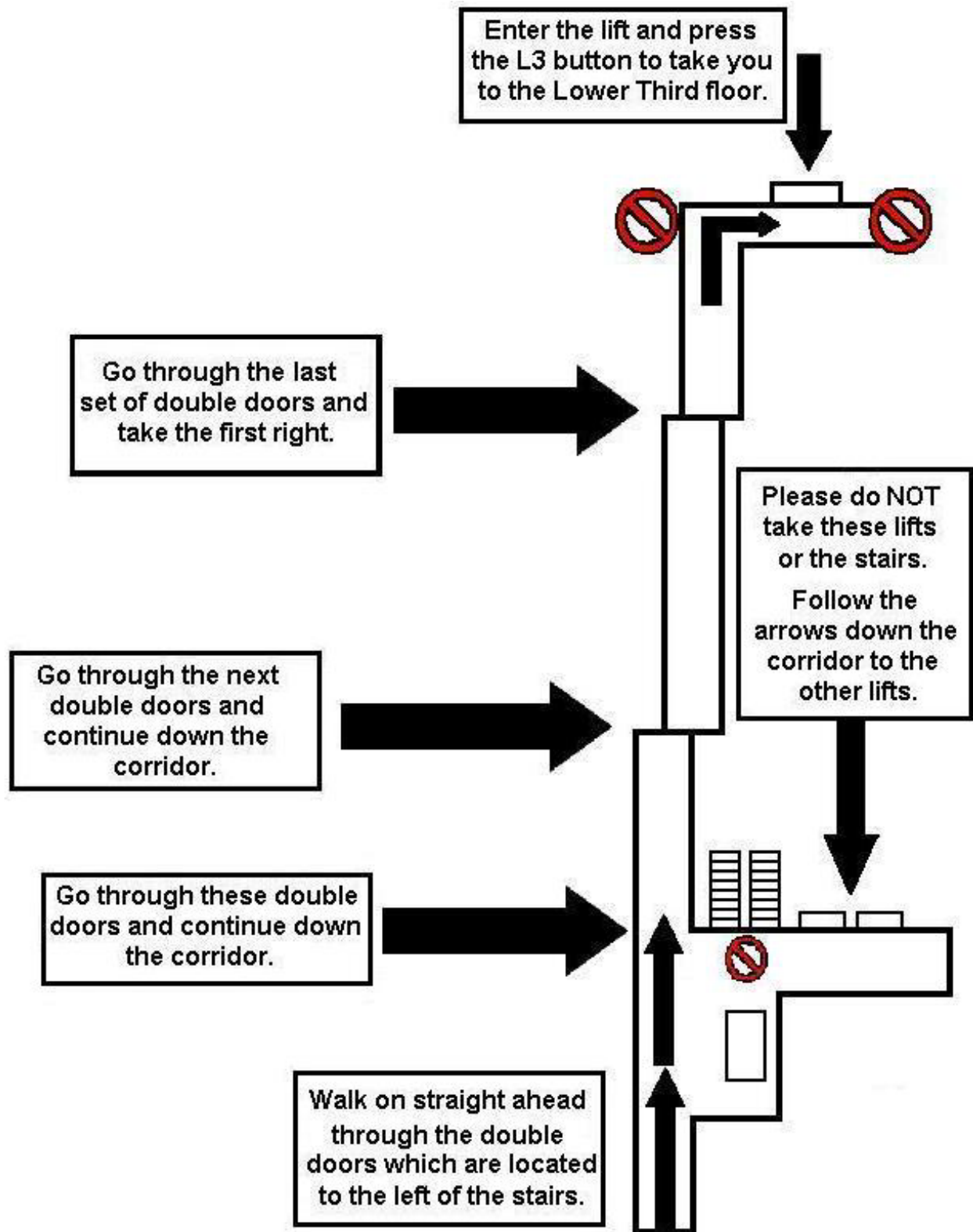

## ROWLAND HILL STREET ENTRANCE

## **Disabled parking at the Royal Free Hospital**

There are 12 blue badge bays at the Pond Street entrance; 17 in the lower level visitors' car park and one blue badge bay outside A&E (lower ground floor). These are free for blue badge holders staying up to four hours – please see details on how to register your badge below. Standard parking charges of £3 an hour will apply after 4 hours.

Please register your details on arrival at either the Pond Street reception or Security reception (adjacent to A&E) to ensure that you receive your four hours free hospital parking. You must take your Government-issued disabled permit with you to register. You will not be required to return to your car to display this. Failure to register your blue badge will lead to a parking notice.

Please note that regular parking charges are applicable to blue badge holders when not using disabled parking.

### ***Drop off zone***

There is a set-down parking zone (immediately outside the main entrance). It is free, but there is a strict no-waiting policy in force and you must leave the area within five minutes of arrival.